

Polarity

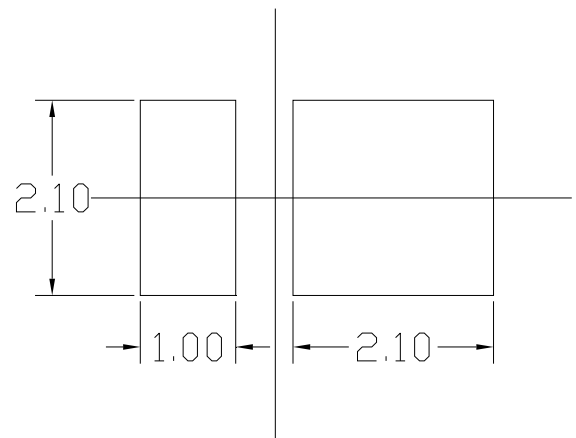
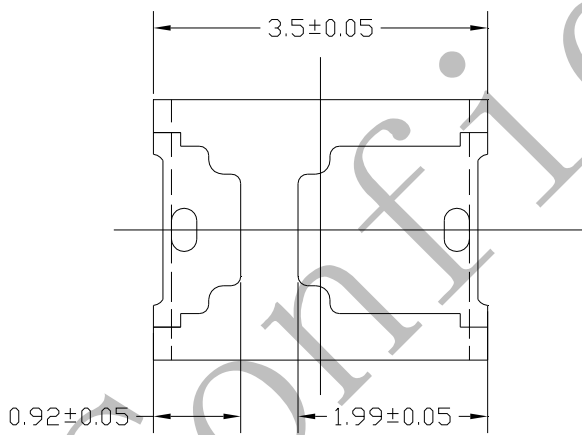
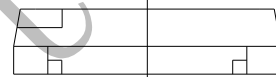
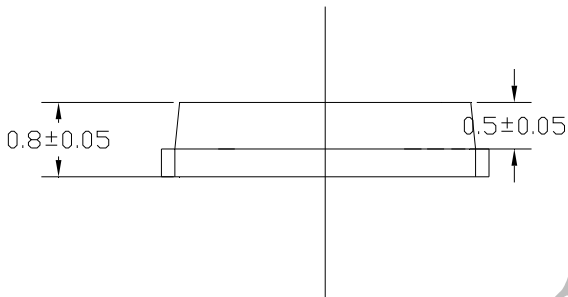

View

Soldering Patterns

2.8*3.5*0.8mm

NOTES:

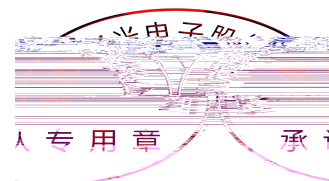

CO

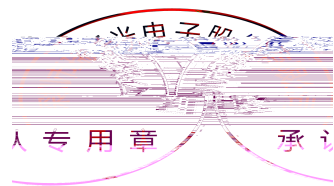

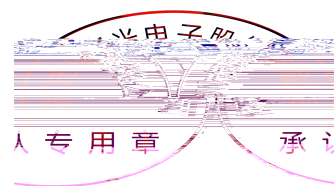

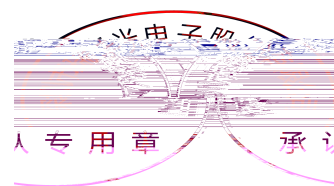

PART NO.	Part Number
SPEC	SpecNumber
LOT NO.	Lot Number
BIN CODE	Bin Code
	Luminous flux
WLD	Dominant wavelength
VF	Forward Voltage
QTY	Packing Quantity
DATE	Made Date



Confidential

Test Items	Ref.Standard	Test Condition	Time	Quantity	Ac/Re /
Reflow	JESD22-B106	Temp:260 max T=10 sec	2times.	10Pcs.	0/1
Thermal Shock	JESD22-A106	-40 15min 100 15min	100 cycle	10Pcs.	0/1
High Temperature Storage	JESD22-A103	Temp:105	1000Hrs.	10Pcs.	0/1
Low Temperature Storage	JESD22-A119	Temp:-40	1000Hrs.	10Pcs.	0/1
Life Test	JESD22-A108	Ta=25 IF=60mA	1000Hrs.	10Pcs.	0/1
High Temperature High Humidity Life Test	JESD22-A101	60 / 90%RH IF=60mA	1000Hrs.	10Pcs.	0/1

Test Items	Symbol	Test Condition	Criteria For Judgement	Applicable project
------------	--------	----------------	------------------------	--------------------

Forward Voltage	Vf	I I	/ I	M/1
-----------------	----	-----	-----	-----

Confidential

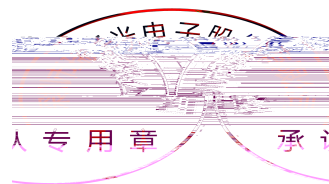

1>.LED operating environment and sulfur element composition cannot be over 100PPM in the LED mating usage material. This is provided for informational purposes only and is not a warranty or endorsement.LED
LED 100PPM 900PPM

Confidential

6>.Compared to standard encapsulants, silicone is generally softer, and the surface is more likely to attract dust requiring special care during processing. In cases where a minimal level of dirt and dust particles cannot be guaranteed, a suitable cleaning solution must be applied to the surface after the soldering of components. Refond suggests using isopropyl alcohol for cleaning. In case other solvents are used, it must be assured that these solvents do not dissolve the package or resin. Ultrasonic cleaning is not recommended. Ultrasonic cleaning may cause damage to the LED.

LED

7>. Storage

If the moisture absorbent material (silica gel) has faded away or the LEDs have exceeded the storage time, baking treatment should be performed after unpacking and based on the following condition: (65 5) for above 24 hours

If the package is flatulence or damaged, please notify the sales staff to assist

8>.Similar to most Solid state devices; LEDs are sensitive to Electro-Static Discharge (ESD) and Electrical Over Stress (EOS). LED

9>.There should be

.When you have special quality requirement for the product, please kindea se

13>.Other points for attention, please refer to our LED user manual.

This specification is written both in English and in Chinese and the latter is formal.

Both the customers and Refond will agree on official specifications of supplied products before a customer's volume production.

Confidential

